

THE CITY OF SPRUCE GROVE

BYLAW C-1039-18

LAND USE BYLAW AMENDMENT

WHEREAS, pursuant to the *Municipal Government Act*, R.S.A., 2000, c.M-26, a municipality shall pass a land use bylaw and may amend the land use bylaw;

AND WHEREAS, the City of Spruce Grove wishes to amend Bylaw C-824-12, the Land Use Bylaw for the City of Spruce Grove;

NOW THEREFORE, the Council for the City of Spruce Grove, duly assembled hereby enacts as follows:

1. This bylaw is called “Greenbury Stage 10”.
2. Bylaw C-824-12 containing the Land Use Districts Map, be amended as follows:
 - 2.1 To redistrict part of Plan 132-4055, Block A, Lot 2 from UR – Urban Reserve District to R1 – Mixed Low to Medium Density Residential District and P1 – Parks and Recreation District. As shown on the map below (See Figure 1).

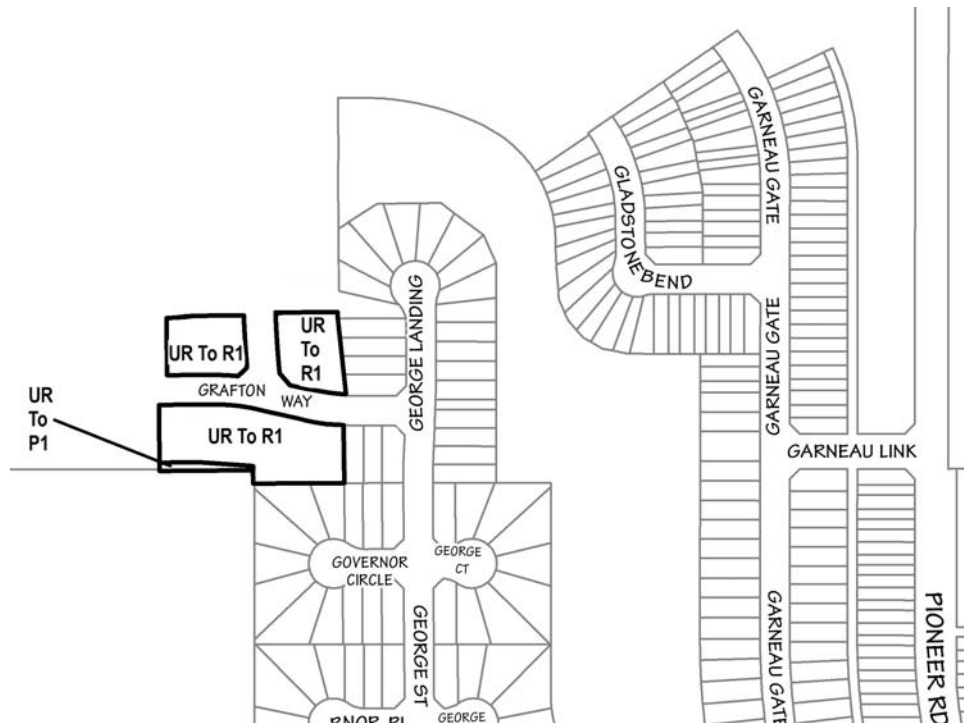

Figure 1 - Proposed Greenbury Stage 10 Redistricting.

3. This amending bylaw shall be consolidated into Bylaw C-824-12.
4. This bylaw shall come into force and effect when it receives third reading and is duly signed.

First Reading Carried July 16, 2018

Public Hearing Held August 13, 2018

Second Reading Carried August 13, 2018

Third Reading

Date Signed

Mayor

City Clerk