

THE CITY OF SPRUCE GROVE

BYLAW C-1039-18

LAND USE BYLAW AMENDMENT

WHEREAS, pursuant to the *Municipal Government Act*, R.S.A., 2000, c.M-26, a municipality shall pass a land use bylaw and may amend the land use bylaw;

AND WHEREAS, the City of Spruce Grove wishes to amend Bylaw C-824-12, the Land Use Bylaw for the City of Spruce Grove;

NOW THEREFORE, the Council for the City of Spruce Grove, duly assembled hereby enacts as follows:

1. This bylaw is called “Greenbury Stage 10”.
2. Bylaw C-824-12 containing the Land Use Districts Map, be amended as follows:
 - 2.1 To redistrict part of Plan 132-4055, Block A, Lot 2 from UR – Urban Reserve District to R1 – Mixed Low to Medium Density Residential District and P1 – Parks and Recreation District. As shown on the map below (See Figure 1).

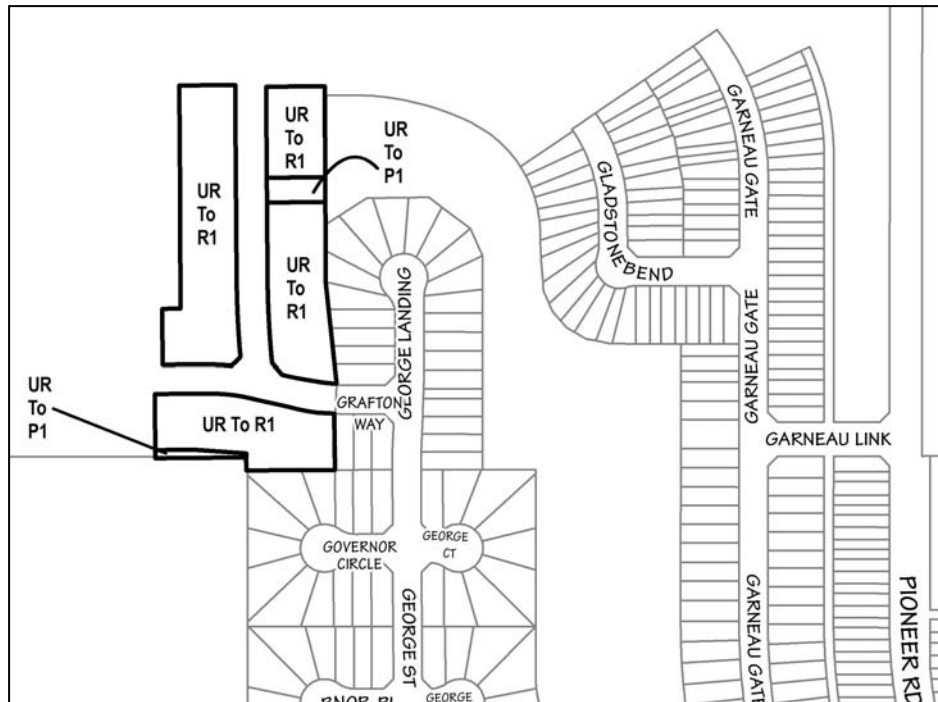

Figure 1 - Proposed Greenbury Stage 10 Redistricting.

3. This amending bylaw shall be consolidated into Bylaw C-824-12.
4. This bylaw shall come into force and effect when it receives third reading and is duly signed.

First Reading

Public Hearing

Second Reading

Third Reading

Date Signed

Mayor

City Clerk